

Lovello™ Sink Collection

Designed for LG Hausys, the Lovello™ stainless steel sink collection offers its own unique design to complement any style or décor.



Solid Surface Integrated Sinks

LG Hausys offers a variety of solid surface sinks to complement your countertop. The sinks are available in four popular solid colors: Arctic White, Ivory White, Cream and Almond.



 **LG Hausys**

900 Circle 75 Parkway, Suite 1500
Atlanta, GA 30339
866-544-4622

To order samples or learn more about HI-MACS®, please visit our website:
www.LGhimacsUSA.com

Introducing HI-MACS®

A NEW GENERATION OF INSPIRATION

There are NO Limits -
The new generation of inspiration is here.

Design has no boundaries and imagination leads the way. From functional kitchen surfaces and spaces to 3-dimensional installations, the unique properties of HI-MACS® Solid Surface material allows you the ability to create what once could only be dreamt.



Not all HI-MACS® colors are SCS certified. Please refer to the related page for more information.

A NEW GENERATION
OF **INSPIRATION**

- GALAXY
- MARMO
- VOLCANICS
- EDEN PLUS
- CLASSIC

HI-MACS®



NOT ALL PRODUCTS ARE PRODUCED IN THE UNITED STATES.
PLEASE CHECK THE RELEVANT PAGE FOR PRODUCT SPECIFICATIONS.

HI-MACS® Benefits

Made in USA

- HI-MACS® is made in USA* in Adairsville, GA just north of Atlanta.
- * Select colors are manufactured outside of the United States.



Sustainability

- HI-MACS® is environmentally friendly and eligible for LEED® points.
- Greenguard and NSF(National Sanitation Foundation) certified.
- Member of U.S. Green Building Council
- SCS Certified (Select colors)



Thermoformable

HI-MACS® can be heated and bent during the fabrication process enabling the product to meet the most challenging of designs.

Hygienic and Self-Sealing

Stain Resistant

Low Maintenance

Renewable & Repairable

15 Year Transferable Warranty

MARMO COLORS

HI-MACS Marmo embodies the organic look of natural stone.

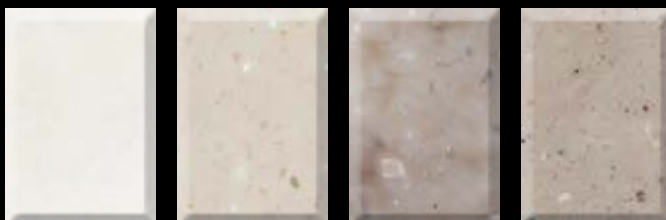

Genova* M209 Firenze* M103 Lucca* M203 Terni* M201

GALAXY COLORS



Colors fused with large chips to emphasize today's quartz style.



Milky Way T009 Venus T001 Cosmos T002 Saturn T003



Pluto T005 Volcanic Ice GT918

EDEN PLUS COLORS



Featuring certified pre-consumer recycled material.



Poppy Seed GT939 6% Recycled Content Oatmeal GT938 6% Recycled Content Barley GT937 6% Recycled Content Ripe Cotton G518R 10% Recycled Content

★ HI-MACS® colors noted contain *minimum 6% or 10% of recycled content.*



Lemongrass G503R 10% Recycled Content Honeysuckle G504R 10% Recycled Content Cocoa G501R 10% Recycled Content

VOLCANICS COLORS

Large translucent chips in HI-MACS dazzling color options.



Tambora VE01 Casera* VE24 Lattitude* VE21 Shasta* VE26



Merea* VL22 Cameroon* VN21 Basil* VG22 Dorado* VB24



Kohala* VN24 Merapi VB01

CLASSIC COLORS



Let your space speak in exciting and original ways.



Arctic White S006 Alpine White S028 Ivory White S029 Cream S009 Almond S002



Arctic Granite G034 Tundra Quartz G065 Birchwood G124 Birch Bark NR G714 Cotton Dust G123



Moon Haze G118 Coswal G125 Macchiato G111 Cappuccino G117 Maui Quartz G223R



Sonoran Granite G075 Cork GT911 Hazelnut Shell GT934 Bellany GT933 Poplar NR G711



Maple Meadow G121 Gray Granite G017 Sugar Maple NR G710 Mesa Granite G073 Umber Granite G605

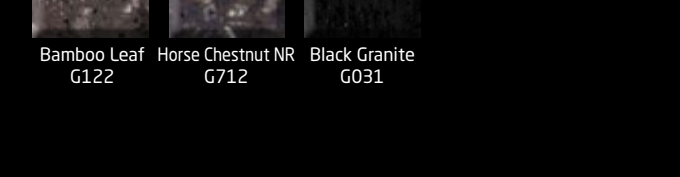

Bamboo Leaf G122 Horse Chestnut NR G712 Black Granite G031

★ HI-MACS® Classic Colors noted can be supplied with *minimum 35% of recycled content*. However, the supply of recycled content product may be limited due to the availability of recycled raw material. Please contact an LG Hausys representative for more information.

All HI-MACS® colors are available in 1/2" thickness.

◆ Colors noted are available in 1/4" thickness. Other HI-MACS® colors can be available in 1/4" thickness upon request.

Colors marked with an asterisk(*) are manufactured overseas.

Colors have unique qualities. Printed representation of colors may vary from actual samples. Please view actual product prior to purchase.

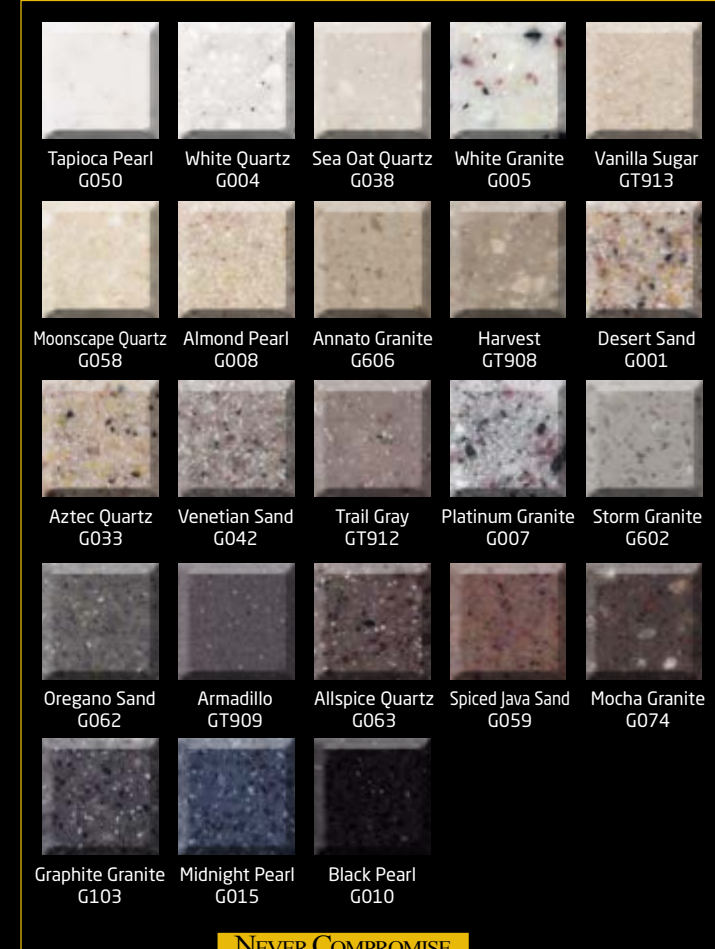

NEVER COMPROMISE COLLECTION



DESIGNER SOLID COLLECTION

Marmo Collection colors exhibit increased movement and variation of color and pattern which cannot be fully recognized on some samples. Seams may be more noticeable due to these variations. Ask to see an actual installation for the best representation.

Monza* M206

Canossa* M202

Bergamo* M204

Pisa* M207

Parma* M205

LG HI-MACS offers a variety of solid surface sinks to complement your countertop. From vanity bowls, double bowls, single bowls, or bar sinks — each provides a seamless look providing easy maintenance and cleaning. With the integrated appearance, the sinks become flush with your countertop showing no seams or lines. The sinks are available in four popular solid colors: Almond, Arctic White, Cream, and Ivory White.

Available in four popular colors:



Technical Bulletin: Routing points for LG®/Transolid® 1612 and 1914 lavatory bowls



1318
Length x Width x Depth
11" x 15-7/8" x 7-7/8"



1517
Length x Width x Depth
13-1/4" x 14-5/8" x 7-7/8"



1612
Length x Width x Depth
16" x 12" x 5"



1914
Length x Width x Depth
19" x 13-1/2" x 6"



2318
Length x Width x Depth
20-3/4" x 15-3/4" x 8-3/4"



2818
Length x Width x Depth
26" x 15-3/4" x 9"



3118
Length x Width x Depth
14-1/16" x 16-1/8" x 8-1/2"
14-1/16" x 16-1/8" x 8-1/2"



3218
Length x Width x Depth
17-7/8" x 16-1/8" x 8-1/2"
10-3/16" x 16-1/8" x 6"



3221
Length x Width x Depth
11-1/4" x 15-3/8" x 7"
17-1/2" x 19" x 8-7/8"

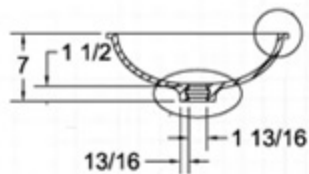
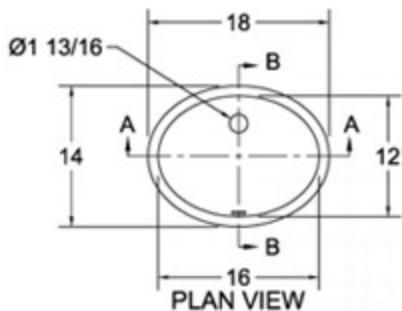

CROSS SECTION A-A

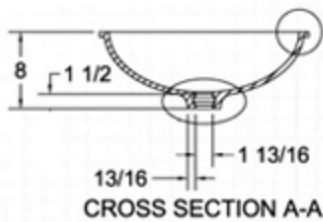
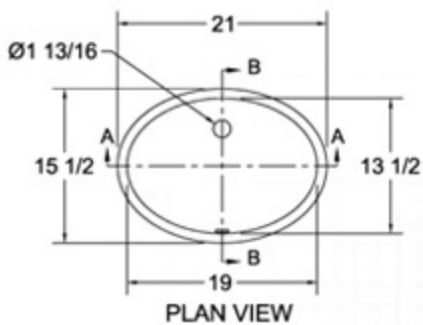

Routing points for LG®/Transolid® 1612 and 1914 lavatory bowls

In the last year, Transolid® has received some feedback from fabricators about our lavatory bowl bits. We have spent several months analyzing the data and determining the best approach to address these issues.

The main issue fabricators have mentioned is that the lavatory bowl bits are not routing enough of the bowls/flash that they should be. After analyzing many bowls, we agree.

The source of the problem is in the finishing of the bowls at the plant. Depending on what sanding is required of each bowl after demolding, our sanders have done their best to produce the best looking bowl in the marketplace. While this goal was being achieved, some aggressive sanding near the rim altered the routing angle.

To address this issue, we are taking the following actions:

1. At the plant level, we will minimize the sanding right at the edge*. Meanwhile, we will continue to produce the most attractive bowls in the marketplace while better maintaining the proper angle at the top of the bowl.
2. Velepec has teamed with Transolid® to develop an additional solution. Velepec is adding 2 degrees to the 30-153 (changing from 13 degrees to 15 degrees). These extra 2 degrees are an excellent compromise for reducing more flash around the bowl, while not taking too much. (If too much is routed, more sanding will always be required.) With the 15 degree bit, the bowls that were sanded properly at the plant will leave a minimal amount of sanding for the fabricator. In addition, the few bowls that have been more aggressively sanded at the plant will be much easier for the fabricator to sand.
3. For bits that have been face sharpened, an additional 15/16" (.950") diameter bearing is available. We recommend replacing the VT-525 with the VT-195 after one or two sharpenings. The VT-195 is a stock bearing available through your local distributor (list price is \$20.00). While this approach leaves a little ledge sometimes (depending upon how much of the face of the carbide has been removed) the sanding is easier than any overhang or flash.
Tip: Some sharpeners will turn the velvet touch bearing to a smaller diameter to match the cutting surface if requested for better routing and sharpening.

* While sanding will be minimized, occasionally some aggressive sanding will be required in small, isolated areas to remove small molding defects. The new and improved angle on the router bit will aid in fabrication.

The net result is that these solutions will give fabricators a much easier time in the shop, saving time and money.

Thank you,

Jeff Smith
Transolid, Inc.
Product Manager
Tel (800) 660-7660
jsmith@transolid.com

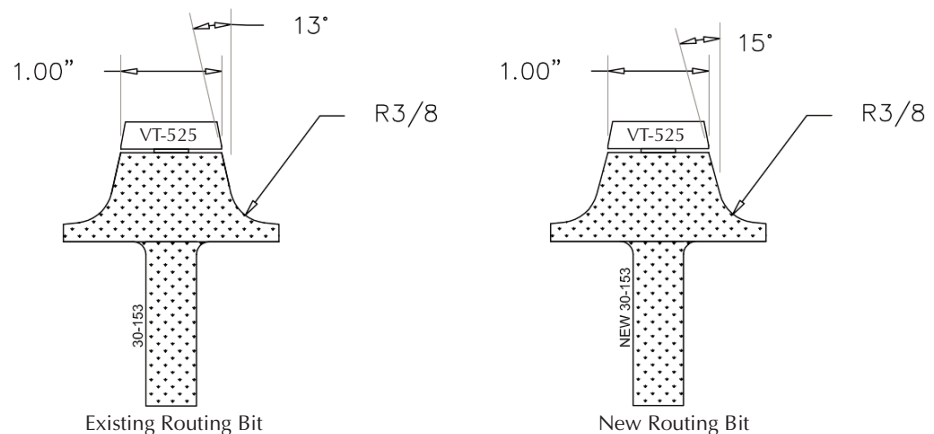

Starting here changes everything.

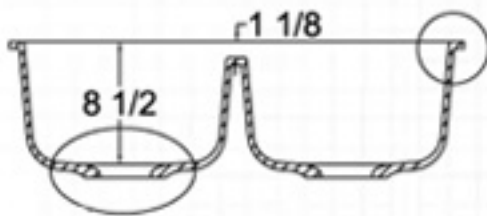
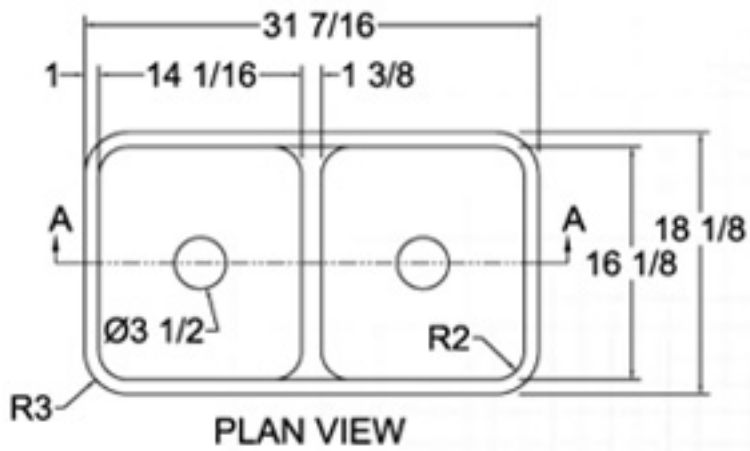

SKU#3118

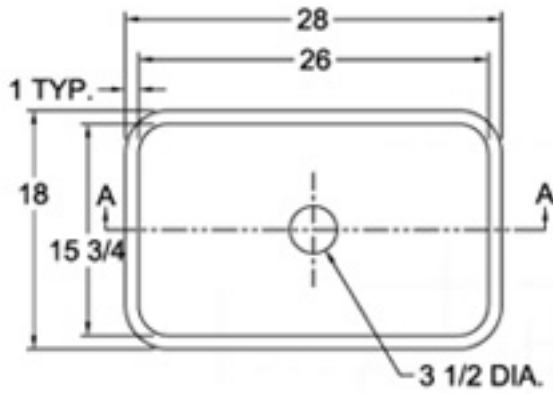

PLAN VIEW

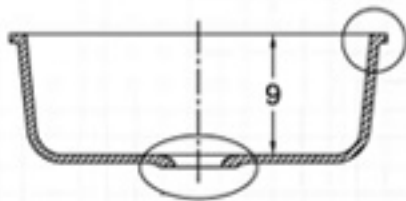

CROSS SECTION A-A

SKU#2818